

GUIDE

non-woven wallpaper

What do you need?



Important before applying the wallpaper:

- Let the wallpaper acclimate for 24 hours. This prevents shrinkage in the wallpaper.
- The optimal wallpapering temperature is between 18–25°C and a humidity level of 40%–65%.
- Ensure the wall is clean, dry, and uniformly colored. The wall should also be smooth (no texture or irregularities).

Plastered or new walls

- If your wall is freshly plastered, treat it with primer.
- New, untreated walls must be pre-treated. You can also choose to paint the wall with white paint.
- These pre-treatments help the wallpaper adhere better to the wall.

1

Preparation

- Turn off the power to the outlets and switches in the wall and remove the frames.
- Remove old wallpaper and ensure the wall is clean and even.
- Cover the floor with newspapers, cloths, or plastic sheets.
- Set up a sturdy ladder to press the wallpaper onto the entire wall.
- Carefully take the wallpaper out of the box and check for any irregularities.
- Make sure the wallpaper is in order before starting to apply it.

Tip: you get the best result if your wall has a uniform color.

2

Lead line

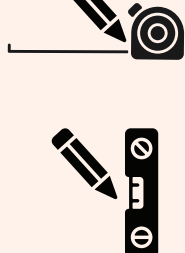

- Measure the first strip of wallpaper on the wall and mark it with a pencil.
- Make a vertical line from this mark using a level.

Note: Added extra margin when ordering? Center the strip on the wall.
Example: With an extra margin of 3 cm, the wallpaper should protrude 1.5 cm at the top and bottom. This gives you extra margin if the ceiling or floor is sloped. The same applies to a margin in the width.

3

Gluing and applying

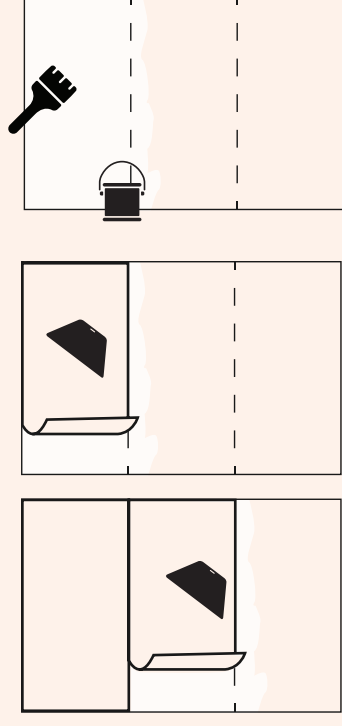

- Prepare the glue (see glue instructions).
- Apply glue to the first strip of the wall. Do this slightly wider than the plumb line.
- Place the strip from top to bottom tightly along the plumb line.
- Press the wallpaper firmly against the wall using the wallpaper spatula.
- Cut around the outlets.
- Repeat these steps until all wallpaper strips are applied.

4

Finishing

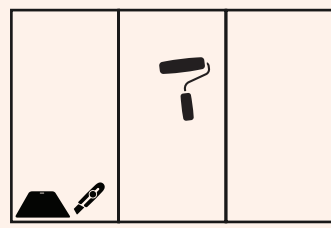

- Trim the wallpaper edges clean with the wallpaper spatula and utility knife.
- Press the wallpaper firmly with the pressure roller and the seams with the seam roller.

Tips:

- Wallpapering around a window or other obstacle? First, place the strips entirely over it and then cut them piece by piece along the frame. **Do not cut the entire strip to size in one go.**
- Small air bubbles will disappear when drying. Large air bubbles can be pricked with a pin to release the air.
- Remove excess glue with a **dry cloth**.
- Ensure sharp folds at corners. This makes cutting away excess wallpaper easier.